

SYSTEM CONDENSING BOILER - TECHNICAL DETAILS

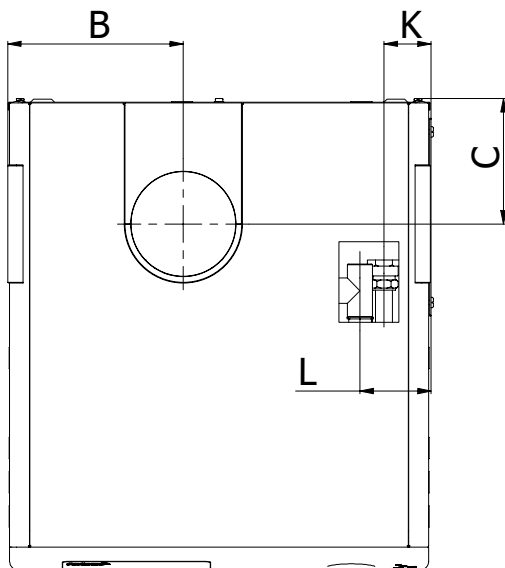
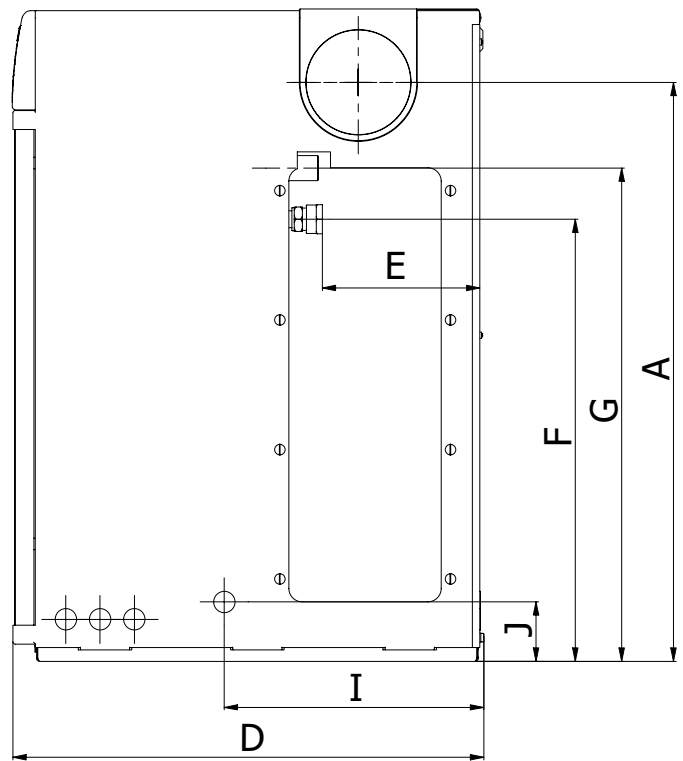
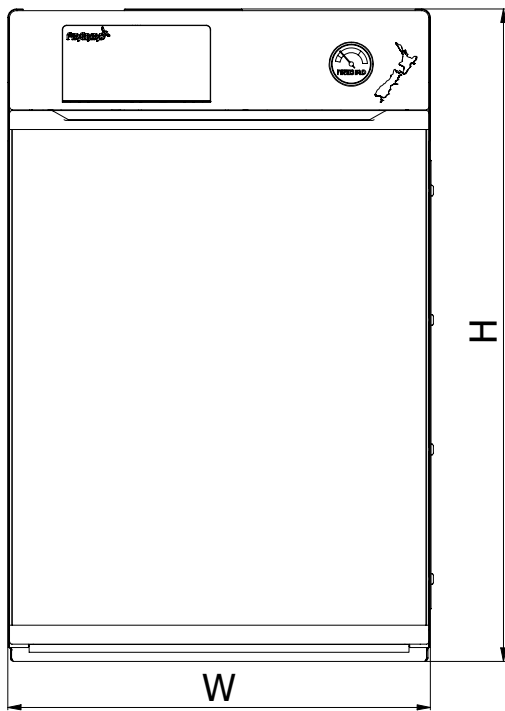

Model - System Condensing (output range)	Weight kg	Dimensions (mm)													
		H	W	D	A	B	C	E	F	G	I	J	K	L	
C26 System Condensing 26kW	148	856	555	618	760	231	165	210	580	648	341	78	62	93	
C35 System Condensing 35kW	151	856	555	618	760	231	165	210	580	648	341	78	62	93	

3 SYSTEM CONDENSING BOILER - TECHNICAL DETAILS

HEAT OUTPUT	kW	26	35
CONNECTIONS		-	-
Heating Flow		22 mm dia.	28 mm dia.
Heating Return		1" BSP	1" BSP
Mains Cold Feed (Copper)		15 mm dia.	15 mm dia.
Drain Off Valve		½" BSP	½" BSP
Safety Pressure Valve Outlet (Copper)		15 mm dia.	15 mm dia.
Condensate Trap		22 mm dia. plastic pipe	22 mm dia. plastic pipe
CIRCULATING PUMP		25/60	25/60
Integral Expansion Vessel Normal Capacity		12 litres	12 litres
Expansion Vessel Pre-charge Pressure		1 bar	1 bar
Low Pressure Water Switch?		✓	✓
Filling Loop Included?		✓	✓
WATER CONTENT		-	-
Boiler		24 litres	24 litres
FLUE (INDOOR BOILERS)		-	-
Balanced Flue Assembly		125 (5") mm dia.	125 (5") mm dia.
Max. Low Level Flue Length		1.5m	1.5m
Max. High Level Balanced Flue Length		6m	6m
HEATING SYSTEM (SEALED)		Fit in accordance with BS 7074 Part 1, BS 5449, OFTEC standards and all other relevant legislation.	
Max. Operating Pressure		2 bar	2 bar
Max. System Pressure Cold		1.5 bar	1.5 bar
Min. System Pressure Cold		0.5 bar	0.5 bar
Preset Pressure Relief Valve		3 bar	3 bar
WATER SIDE RESISTANCE			
Flow Rate To Give A Nominal Output At 10K Differential		26kW	35kW
Flow Rate Measured		2135 kg/h	2874 kg/h
Waterside Resistance		0.18 mbar	0.18 mbar
Flow Rate To Give A Nominal Output At 20K Differential		26kW	35kW
Flow Rate Measured		1131 kg/h	1523 kg/h
Waterside Resistance		0.19 mbar	0.19 mbar